

B
BESPOKE YACHT CHARTER®

FAST & FURIOUS



FAST & FURIOUS

Length: 44.60 m (146' 4")

Beam: 8.30 m (27' 3")

Draft: 1.30 m (4' 3")

Number of Guests: 10

Number of Crew: 8

Built: 2016

Refit:

Builder: AB Yachts

Naval Architect: AB Yachts

Flag: British Virgin Islands

Hull Construction: GRP

Hull Configuration: Planing hull

Equipment: WiFi connection on board, Stabilisers underway, Stabilisers at anchor, Air conditioning

FAST & FURIOUS is an athletic superyacht and the largest in the AB YACHTS sporty range. Her striking and eye-catching exterior features characteristic portholes and smooth lines. Speed lovers will enjoy zipping between ports at a maximum speed of 42 knots with excellent stability. Her immaculate interior with patterned woods, neutral warm colours and high-end luxurious finishes makes her one of the most attractive yachts in the sporty category. The large flybridge and aft deck are ideal for al fresco dining and sunbathing.

Key Features

- 1** Twice finalist at the World Superyacht Awards and ShowBoat Design Awards in 2016
- 2** 12m Seawater Smeralda chase boat
- 3** Contemporary and bright living areas
- 4** Shallow draft for exclusive visits to secluded beaches and reefs
- 5** Fastest 40m+ available on the charter market reaching a max speed of 42 knots
- 6** Wide outdoor deck spaces for entertainment



Cruising



Aerial

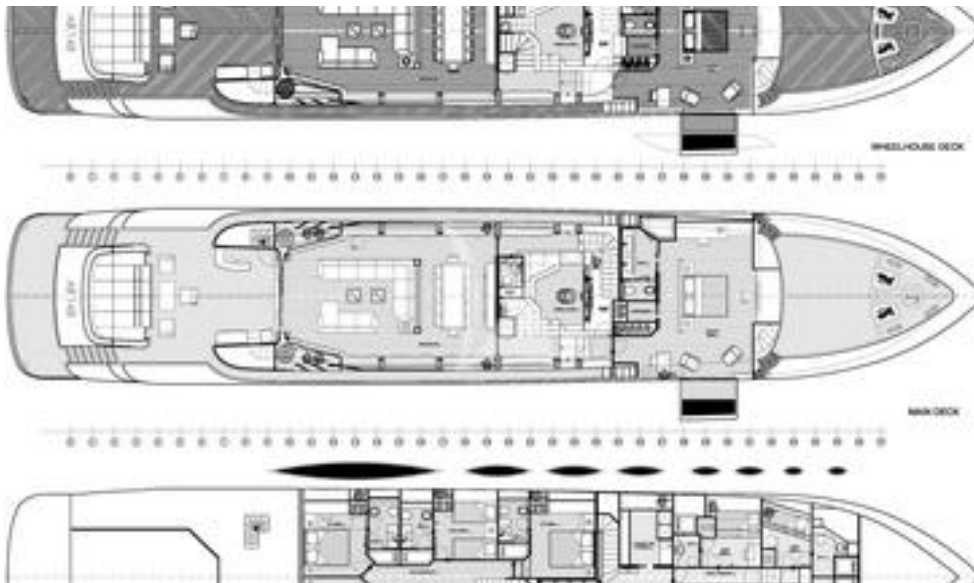

GA



Main Balcony



Master Bathroom



Cockpit lifestyle



Cockpit



Sun deck



VIP 1



Twin



Sun beds



Main Table salon



VIP 3



Gym, Yoga space



VIP Bathroom



VIP 2



Main Salon



Master



Master with view



Foredeck

SPECIFICATIONS

ACCOMMODATION

Number of guests: 10

Number of cabins: 5

Cabin configuration: 4 Double Cabins, 1 Twin Cabins

Bed configuration: 1 King Beds, 3 Queen Beds, 2 Single Beds

EQUIPMENT

Engines: Engines: 3 x 2,600hp MTU 16V2000 M94
Generators: 2 x 70kW Kohler (silenced) with parallel
Fuel consumption: Cruising Speed 20 KTS Max Speed 42 KTS
Fuel Consumption (cruising) 12 KTS - 295 L/H 20 KTS - 654 L/H
30 KTS - 930 L/H 40 KTS - 1500 L/H

Cruising Speed: 20 knots

Fuel Consumption: 654 Litres/Hr

WATERSPORTS

Tender + Toys: 1x Seadoo Spark Jetski
1x 10m (33ft) Seawake Smeralda 320 Tender
1x iAqua Seadart Pro
2x Yamaha Seawing II
1x wakeboard
1x inflatable sofa
2x paddle boards & paddles
2x inflatable dock platforms
9x Cressi fins
9x cressi face masks
3x masks + snorkel set

LAYOUT

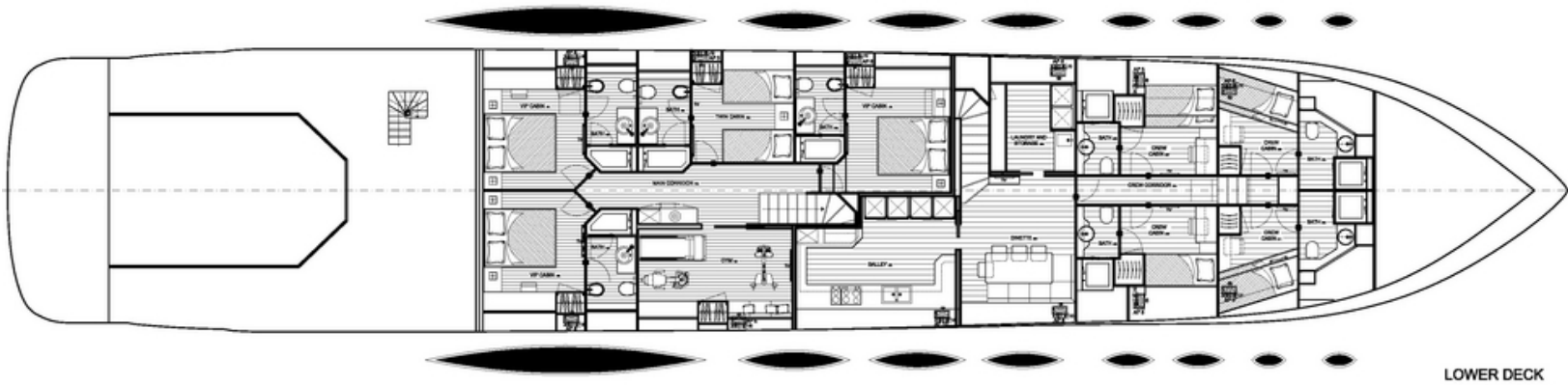
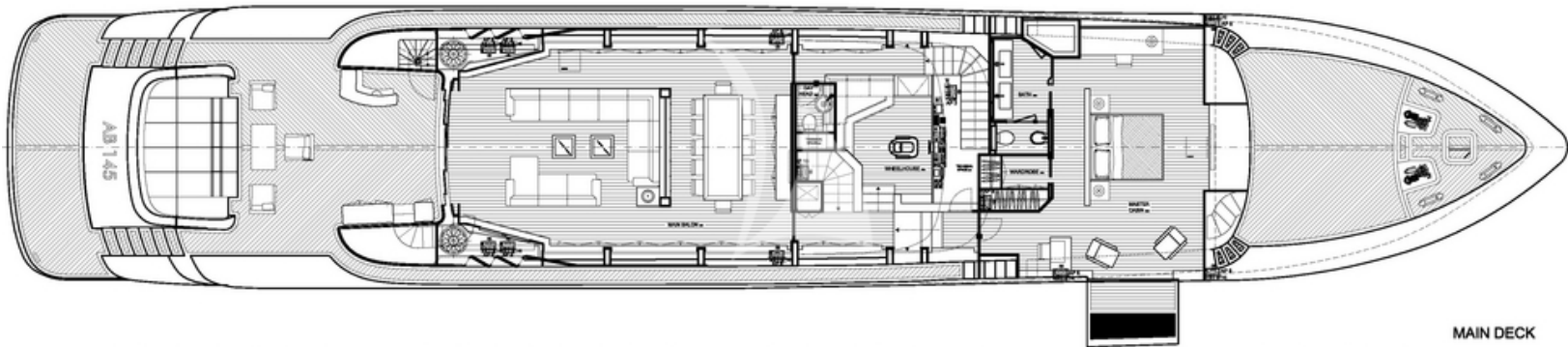
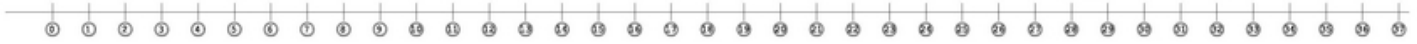
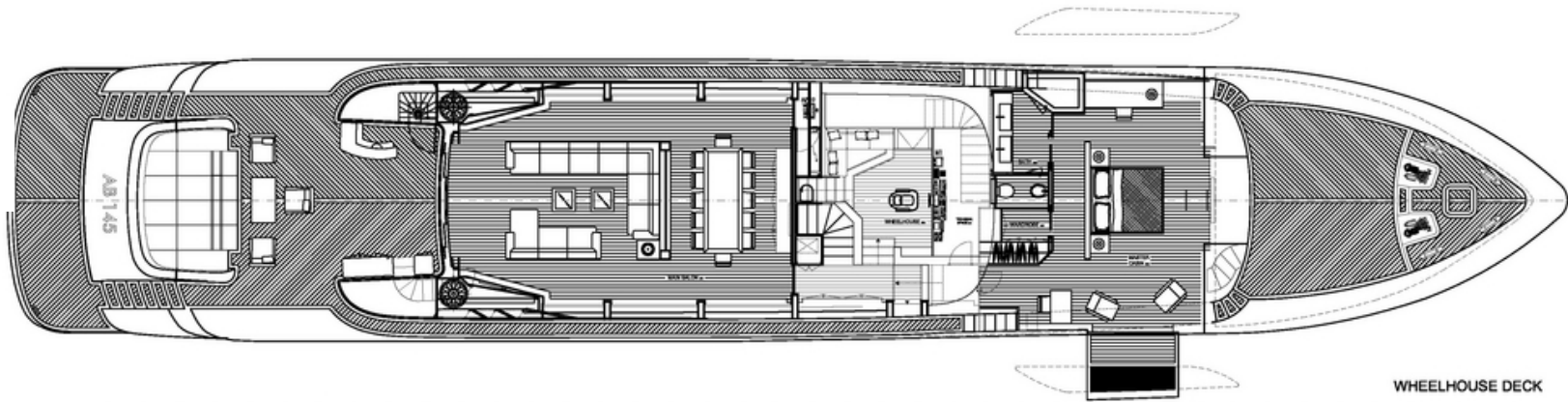



Bespoke Yacht Charter

UK, London, W8 4DB

Tel: +44 20 7368 3328

info@bespokeyachtcharter.com

<http://www.bespokeyachtcharter.com>

Disclaimer

This document is not contractual. All specifications are given in good faith and offered for informational purposes only. The publisher and company do not warrant or assume any legal liability or responsibility for the accuracy, completeness, or usefulness of any information and/or images displayed. Yacht inventory, specifications and charter prices are subject to change without prior notice. None of the text and/or images used in this brochure may be reproduced without written consent from the publisher.